

## RUBBER INNER GEARSHIFT BOOTS

FOR ALFA ROMEO, FIAT, PININFARINA

Compare your original boots to illustrations. For leather (console) shift boots, see page 80.



**INNER GEARBOX BOOT** for Fiat 124 Spider and Coupe, 1969-78, 2000 and Pininfarina Spider, 1979-85. #04751, **\$18.95**



**OUTER GEARBOX BOOT** 1955-68 Alfa Romeo, all; and 1969 Spider. Middle gearbox boot 1971-on Alfa Spider. #93552, **\$18.65**

### INNER GEARBOX BOOT

1955-68 Alfa Romeo, all, and 1969-on Spider. 3 1/2" diameter. #93551, **\$10.50 ea.**



### LOWER SHIFT LEVER BOOT

Should be replaced when worn, to save wear on shift lever bushings.



Alfa Romeo Alfetta, GTV6, 1975-84. #7252, **\$5.95 ea.**  
GTV6, Milano, 1985-89, #7253, **\$7.35 ea.**



**INNER GEARBOX BOOT** Alfa Romeo GTV 1969-74, Berlina 1969-74.

Double boot; 3 1/2" inner, 7" outer diam. #93554, **\$15.50**



### CLUTCH FORK BOOT

Fiat 124, 2000 Spider, all. #04755, **\$8.95 ea.**

## NEW CLUTCH LINKAGE PARTS

FOR ALFA ROMEO & FIAT 124

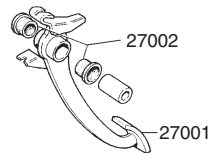

Improved design is stronger!

	Item No.	Price ea.
Alfa Romeo GTV, 1972-74; & Spider, 1972-on		
Clutch pedal pivot pin	06751	<b>\$69.00</b>
Clutch fork-to-pivot ret. spring	06753	<b>8.75</b>
Alfa Romeo GTV6, Milano		
Clutch fork pivot ball	06761	<b>34.95</b>
Fiat & Pininfarina Spiders, 1971-85		
Clutch pedal	27001	<b>42.50</b>
Pedal bushings (need 2)	27002	<b>6.95</b>
Clutch fork	27005	<b>35.95</b>
Lancia Scorpion, Shift Linkage Bushings (need 6)	34029	<b>2.90</b>

See pages 66-74 for Clutch Pedal Pads



## CLUTCH PEDAL PIVOT SHAFT

If your Alfa's clutch pedal does not return to its normal position when released, or if full depression fails to disengage the clutch, you may have a failing pedal pivot shaft (#06751). Inspect the weld connecting the shaft & its arm. If you see cracks, replace it.

## SHIFT LEVER PARTS

FOR FIAT 124, 2000 SPIDER, 1973-85

	Item No.	Price
<b>1</b> Shift lever	4301588	<b>\$78.50</b>
<b>Kit, #2-#5</b>		
(5 pcs.)	36301	<b>12.50</b>
<b>2</b> Nylon collar		
<b>3</b> Rubber bushing		
<b>4</b> Nylon collar		
<b>5</b> Nylon lock ring		
<b>6</b> Spring	4308774	<b>3.95</b>
<b>7</b> Pivot cup	870736	<b>6.95</b>
<b>8</b> Pivot cup	4289498	<b>8.95</b>
<b>9</b> Washer	1263862	<b>.90</b>
<b>10</b> Nut	14048211	<b>.95</b>
<b>11</b> Cover	4289489	<b>5.95</b>
<b>12</b> Bolt (3 req'd.)	13824611	<b>1.85</b>
<b>13</b> Seat	4289497	<b>14.50</b>

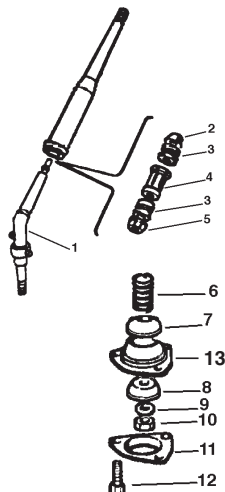

## REFINISHED, BALANCED FLYWHEELS

A proper clutch job includes attention to your flywheel.

**Failure to re-surface your flywheel often results in clutch chatter.**

We now offer flywheels that have been refinished on a dedicated precision flywheel grinder, and carefully re-balanced. **Add a \$100 core charge to each flywheel** that will be refunded when we receive your old, rebuildable unit within 60 days (we will deduct for bad ring gear). Please remove bolts but leave any dowel pins in place.

Alfa Romeo Spider, GTV 1972-74 (130 teeth),	#39396	<b>\$149.00</b>
Alfa Romeo Spider, 1975-81 (131 teeth),	#39397	<b>\$149.00</b>
Alfa Romeo Spider, 1982-89 (131 teeth, Bosch ign.),	#39398	<b>\$155.00</b>
Fiat 2-liter, 1979-85 (w/ 12mm bolt holes),	#39395	<b>\$144.00</b>

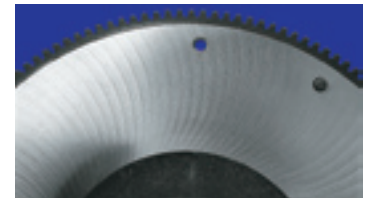

## ALFA & FIAT TRANSMISSIONS

REMANUFACTURED IN ITALY

When you replace your tired, noisy old gearbox, you'll fall in love with your car all over again the first time you slide it into second. Our rebuilt units include all-new synchro rings, sleeves and bearings. **Core charge** is refundable when we receive your old transmission within 60 days. Must be rebuildable, and not disassembled. Must also drain gear oil and clean grease off exterior before shipping to us.

### Alfa Romeo

All 5-speed Spider & GTV, includes shift housing but not bell housing.

#37267, **\$2,290 + \$700 core charge**

Alfa Romeo 5-speed



### Fiat

All 5-speed 124 & Spider, bell housing and shift housing not included

#37266, **\$1,698 + \$550 core charge**

Fiat 5-speed



## BRAND-NEW TRANSMISSIONS

FOR FIAT SPIDER

Now you can install a brand-new 5-speed gearbox in your 1971-on Fiat or Pininfarina Spider or 124 Coupe. From Polski-Fiat, a Fiat licensee in Poland that has built over 1.4 million Fiats. Gearbox bolts in, using your existing bell housing and shift housing.

#37265, **\$2,390**

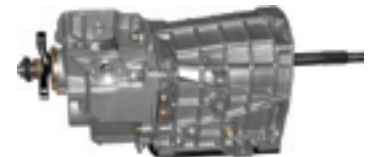

## FLEXIBLE CLUTCH HOSES

Replace whenever you change slave cylinders.

2898

	Item No.	Price
Alfa Romeo, all 4 & 6 cyl., 1969-94, except 164 (also avail. in braided stainless steel; see p. 63)	2898	<b>\$11.95</b>
Alfa Romeo 164 all, without damper	06282	<b>17.75</b>
Fiat X1/9	06254	<b>14.75</b>

