

ALFA ROMEO

Rebuild your gearbox and save money! Gears and bearings fit 1969-on 4-cyl-inder Alfa Romeos except Alfetta. Synchro rings and sleeves fit all 1969-on models including Alfetta, GTV6 and Milano.

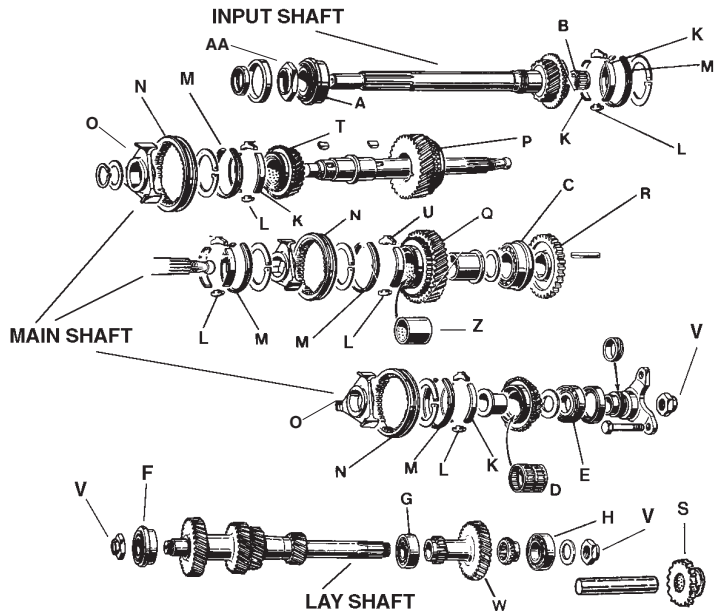

| Item | Item No. | Price |
|------|----------|----------|
| AA | 36304 | \$ 29.95 |
| A | 515945 | 177.50 |
| B | 02753 | 16.30 |
| C | 515945 | 177.50 |
| D | 02755 | 24.95 |
| E | 02757 | 32.95 |
| F | 522887 | 135.50 |
| G | 02759 | 119.00 |
| H | 02758 | 67.50 |
| K | 36254 | 6.25 |
| L | 36253 | 8.95 |
| M | 21603 | 49.50 |
| N | 21905 | 118.50 |
| O | 36282 | 139.50 |
| T, Z | 36257 | 419.00 |
| P, Z | 36256 | 209.50 |
| Q, Z | 36255 | 389.00 |
| R | 36258 | 239.00 |
| S | 36259 | 209.50 |
| U | 36294 | 18.95 |
| | 36263 | 285.00 |
| | 36262 | 276.00 |
| | 36261 | 269.00 |
| V | 36293 | 10.50 |
| W | 36285 | 444.00 |
| Z | 36295 | 41.95 |
| | 29771 | 6.55 |

FIAT 124 SPIDER

For a more complete description of transmission parts available, call for our free Transmission Parts Booklets.

Fiat 124 Spider, 1971-85, #661035, FREE

Note: 4th and 1st gears shown assembled.

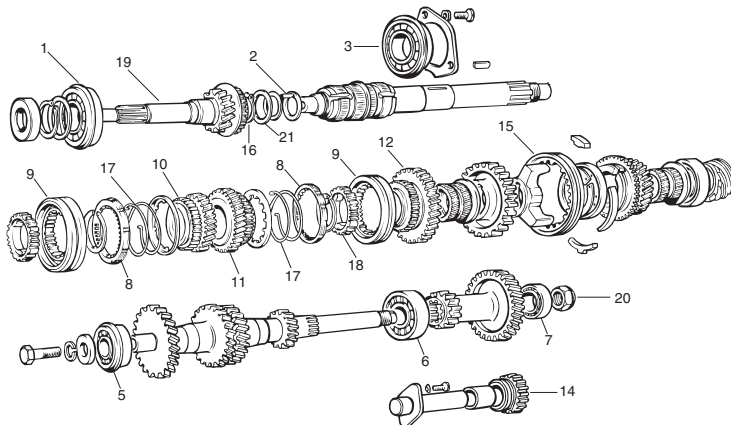

| Item | Item No. | Price |
|------|----------|----------|
| 1 | 4327431 | \$ 49.50 |
| 2 | 16165 | 18.50 |
| 3 | 4059514 | 28.95 |
| 4 | 4274012 | 106.90 |
| 5 | 38166 | 115.50 |
| 6 | 4077339 | 56.50 |
| 7 | 4247746 | 119.50 |
| 8 | 8514 | 20.50 |
| 9 | 8513 | 69.50 |
| 10 | 4191076 | 69.50 |
| 11 | 4155236 | 81.50 |
| 12 | 4177420 | 77.95 |
| 13 | 4318911 | 51.50 |
| 14 | 4073245 | 51.50 |
| 15 | 36268 | 155.00 |
| 16 | 4056239 | 5.80 |
| 17 | 4155829 | 16.95 |
| 18 | 4158515 | 47.50 |
| 19 | 5992106 | 144.50 |
| 20 | 25034 | 3.50 |
| 21 | 37264 | 22.95 |
| | 4294118 | 39.50 |
| | 4129729 | 134.50 |
| | 66078 | 24.70 |



WORN SYNCHROMESH

With a rebuilt gearbox, you'll enjoy smooth, crunch-free shifts. In order to keep your new synchromesh from wearing out, try to develop a light touch on the shifter. When shifting, pause ever so briefly in neutral before moving the lever to the next gear. Try to match the engine revs to where they'll need to be in the next ratio. This greatly reduces the work on your synchro rings and wear on the dog teeth. Also, be sure to use the right gear oil, and check the level regularly.

INPUT SHAFT BUSHINGS

TRANSMISSION-TO-ENGINE (PILOT)



| Item | Item No. | Price |
|--|----------|---------|
| Alfa Romeo 1300, 1600 (20mm) | 11122 | \$23.95 |
| Alfa Romeo 1750, 2000 1971-94 (24mm) | 11121 | 12.95 |
| Alfa Romeo V6, 2.5 and 3.0 L | 11125 | 11.25 |
| Fiat 124, 131 1968-9/83 (Bearing) | 4044 | 16.95 |
| Pininfarina Spider, 10/83 on (Bearing) | 02762 | 25.50 |
| Fiat Strada, X1/9, 1979-on | 4413862 | 8.95 |

Transmission seals are on page 29.