

## ALFA ROMEO

Rebuild your gearbox and save money! Gears and bearings fit 1969-on 4-cylinder Alfa Romeos except Alfetta. Synchro rings and sleeves fit all 1969-on models including Alfetta, GTV6 and Milano.

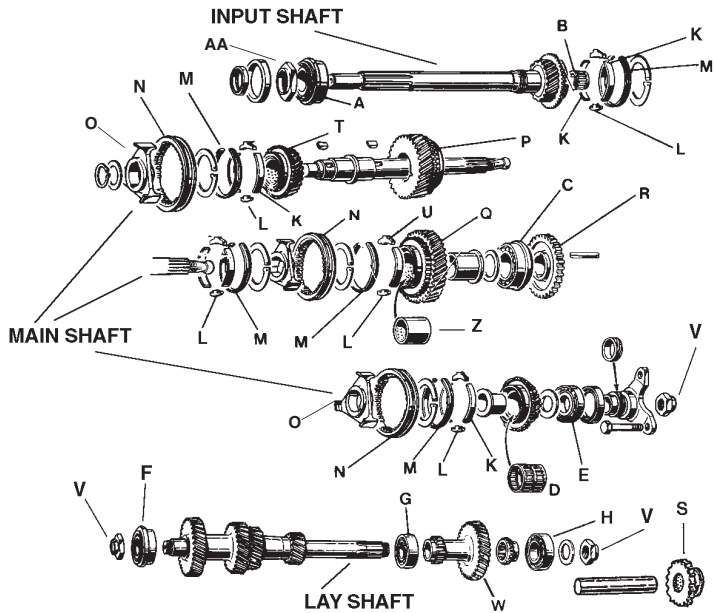

Item	Item No.	Price
AA	Input shaft nut	36304 \$ 29.95
A	Front input shaft bearing	515945 187.50
B	Rear input shaft cage bearing	02753 16.30
C	Front main shaft bearing	515945 187.50
D	Center main shaft bearing	02755 24.95
E	Rear main shaft bearing	02757 33.25
F	Front lay shaft bearing	522887 135.50
G	Center lay shaft bearing	02759 119.00
H	Rear lay shaft bearing	02758 67.50
K	Left or right strap	36254 6.25
L	Lower quadrant	36253 —
M	Synchro ring, moly (need 5)	21603 49.50
N	Synchro sleeve, moly (need 3)	21905 118.50
O	Synchro hub (there are 3)	36282 139.50
T, Z	3rd gear, with bushing	36257 419.00
P, Z	2nd gear, with bushing	36256 219.00
Q, Z	1st gear, with bushing	36255 389.00
R	Reverse gear, large	36258 239.00
S	Reverse gear, small idler	36259 187.00
U	Upper quadrant, 3rd gear	36294 18.95
	Selector fork, 5th and reverse	36263 285.00
	Selector fork, 3rd and 4th	36262 276.00
	Selector fork, 1st and 2nd	36261 269.00
V	Lay shaft nut	36293 10.50
W	Reverse—5th gear	36285 444.00
Z	1st, 2nd, 3rd gear bushing (each)	36295 41.95
	Shift lever seal (under boot)	29771 6.55

## FIAT 124 SPIDER

For a more complete description of transmission parts available, call for our free Transmission Parts Booklets.

Fiat 124 Spider, 1971-85, #661035, FREE

**Note: 4th and 1st gears shown assembled.**

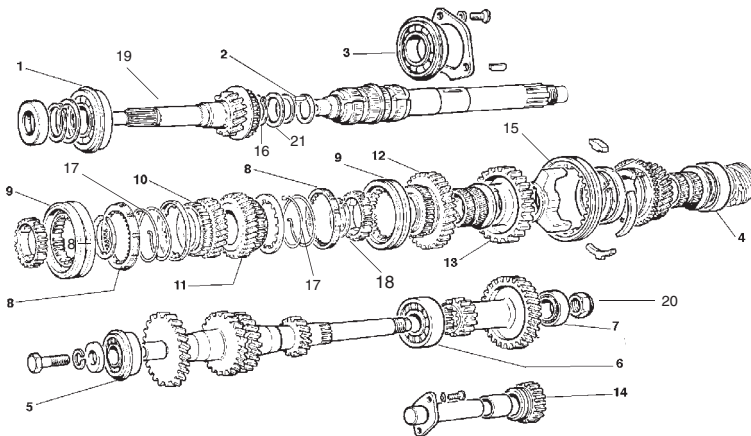

Item	Item No.	Price
1	Front bearing	4327431 \$49.50
2	Needle bearing	16165 18.50
3	Center bearing	4059514 29.95
4	Rear bearing	4274012 75.50
5	Front layshaft bearing, 1973-85	38166 76.75
6	Center layshaft bearing	4077339 55.25
7	Rear layshaft bearing	4247746 119.50
8	Synchro ring - 1-4 (need 4)	8514 22.25
9	Synchro sleeve - 1-2, 3-4 (need 2)	8513 69.50
10	3rd gear	4191076 76.95
11	2nd gear	4155236 81.50
12	1st gear	4177420 77.95
13	Reverse gear, mainshaft	4318911 51.50
14	Reverse idler gear	4073245 51.50
15	Synchro sleeve, 5-R	36268 155.00
16	Circlip (need 1)	4056239 5.80
17	Spring (need 4)	4155829 18.95
18	Synchro hub	4158515 49.50
19	Input shaft with 4th gear, 1972-85	5992106 144.50
20	Layshaft nut	25034 3.95
21	Thrust washer for input shaft	37264 22.95
	Selector fork - 1 & 2, 3 & 4 (need 2)	4294118 39.50
	Selector fork - 5th gear	4129729 134.50
	Gasket set, 1968-85	66078 24.70



### WORN SYNCHROMESH

With a rebuilt gearbox, you'll enjoy smooth, crunch-free shifts. In order to keep your new synchromesh from wearing out, try to develop a light touch on the shifter. When shifting, pause ever so briefly in neutral before moving the lever to the next gear. Try to match the engine revs to where they'll need to be in the next ratio. This greatly reduces the work on your synchro rings and wear on the dog teeth. Also, be sure to use the right gear oil, and check the level regularly.

## INPUT SHAFT BUSHINGS

TRANSMISSION-TO-ENGINE (PILOT)



Item No.	Price
Alfa Romeo 1300, 1600 (20mm)	11122 \$23.95
Alfa Romeo 1750, 2000 1971-94 (24mm)	11121 12.95
Alfa Romeo V6, 2.5 and 3.0 L	11125 11.25
Fiat 124, 131 1968-9/83 (Bearing)	4044 17.55
Pininfarina Spider, 10/83 on (Bearing)	02762 25.50
Fiat Strada, X1/9, 1979-on	4413862 8.95

Transmission seals are on page 25.